



## MK TYPE (ONE-HAND QUICK COUPLING)

Major Applicable Fluid~

Stainless Steel: Frozen Lubricant/Acid/Brine

Brass: Oil/Fresh Water/Air

Steel: Circulating Lubricant/Fresh Water/Air

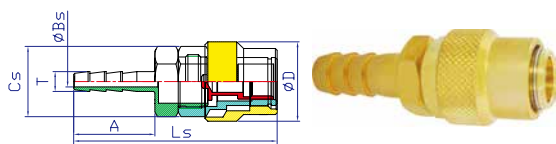

Computer No	Product Sign	Dimension (mm)						Weight (g)			Quantity per Carton
		Ls	D	Cs	A	T	Bs	SS41	BRASS	SUS	
SUS	15SH	56.4	22	Ø19.5*6HEX*17D	22.5	5.5	3	46.5	50.5	47.1	400-B
A2335MKJA	20SH	58.4	22	Ø19.5*6HEX*17D	25	7.2	4	47.9	52	48.5	400-B
BRASS	25SH	58.4	22	Ø19.5*6HEX*17D	25	9	6.2	50.2	54.5	50.8	400-B
A0135MKJA	30SH	58.9	22	Ø19.5*6HEX*17D	25.5	11.3	7	52.5	57	53.2	400-B
SS41	40SH	65.4	22	Ø21.7*6HEX*19D	32	15	9	61.3	66.5	62	400-B
A1135MKJA											

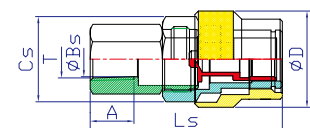

Computer No	Product Sign	Dimension (mm)						Weight (g)			Quantity per Carton
		Ls	D	Cs	A	T	Bs	SS41	BRASS	SUS	
SUS	10SF	42.7	22	Ø18.2*6HEX*16D	9	PT1/8"28P	8	55.3	60	56	400-B
A2335MKJA	20SF	43.4	22	Ø19.5*6HEX*17D	9	PT1/4"19P	9	54.8	59.5	55.5	400-B
BRASS	30SF	45.4	22	Ø21.7*6HEX*19D	11.7	PT3/8"19P	9	58.5	63.5	59.2	400-B
A0135MKJA											
SS41											
A1135MKJA											

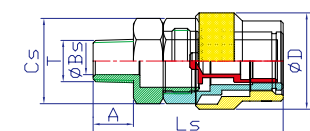

Computer No	Product Sign	Dimension (mm)						Weight (g)			Quantity per Carton
		Ls	D	Cs	A	T	Bs	SS41	BRASS	SUS	
SUS	10SM	43.4	22	Ø19.5*6HEX*17D	9.2	PT1/8"28P	6.2	46.1	50	46.6	400-B
A2335MKJA	20SM	44.4	22	Ø19.5*6HEX*17D	11	PT1/4"19P	7	52.5	57	53.2	400-B
BRASS	30SM	44.4	22	Ø19.5*6HEX*17D	11	PT3/8"19P	9	54.4	59	55	400-B
A0135MKJA	40SM	46.4	22	Ø24*6HEX*21D	13	PT1/2"14P	14	64.5	70	65.3	400-B
SS41											
A1135MKJA											

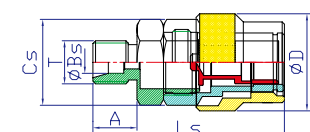

Computer No	Product Sign	Dimension (mm)						Weight (g)			Quantity per Carton
		Ls	D	Cs	A	T	Bs	SS41	BRASS	SUS	
SUS	10SMS	43.4	22	Ø19.5*6HEX*17D	10	PS1/8"28P	5	46.1	50	46.6	400-B
A2335MKJA	20SMS	43.4	22	Ø19.5*6HEX*17D	10	PS1/4"19P	8.1	52.5	57	53.2	400-B
BRASS	30SMS	43.4	22	Ø19.5*6HEX*17D	10	PS3/8"19P	11.5	54.4	59	55	400-B
A0135MKJA	40SMS	46.4	22	Ø24*6HEX*21D	13	PS1/2"14P	12.4	64.5	70	65.3	400-B
SS41											
A1135MKJA											

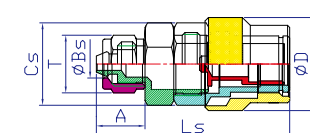

Computer No	Product Sign	Dimension (mm)						Weight (g)			Quantity per Carton
		Ls	D	Cs	A	T	Bs	SS41	BRASS	SUS	
SUS	20SP	45.7	22	Ø19.5*6HEX*17D	11.5	4*6	6.6	51.6	56	52.2	400-B
A2335MKJA	25SP	47.2	22	Ø19.5*6HEX*17D	13	5*8	8.2	55.3	60	56	400-B
BRASS	30SP	49.7	22	Ø19.5*6HEX*17D	15.5	6.5*10	10.2	58.1	63	58.8	400-B
A0135MKJA											
SS41											
A1135MKJA											

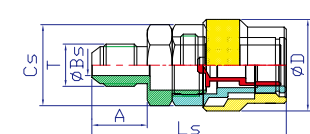

Computer No	Product Sign	Dimension (mm)						Weight (g)			Quantity per Carton
		Ls	D	Cs	A	T	Bs	SS41	BRASS	SUS	
SUS	20SG	46.7	22	Ø19.5*6HEX*17D	13.3	7/16"20P	5	48.4	52.5	49	400-B
A2335MKJA	30SG	48.4	22	Ø19.5*6HEX*17D	15	9/16"18P	8	51.6	56	52.2	400-B
BRASS	40SG	49.9	22	Ø21.7*6HEX*19D	16.5	3/4"16P	10	64	69.5	64.8	400-B
A0135MKJA											
SS41											
A1135MKJA											

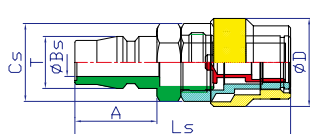

Computer No	Product Sign	Dimension (mm)						Weight (g)			Quantity per Carton
		Ls	D	Cs	A	T	Bs	SS41	BRASS	SUS	
SUS	10SAP	53.9	22	Ø19.5*6HEX*17D	20.5	13	7	55	60	56	400-B
A2335MKJA											
BRASS											
A0135MKJA											
SS41											
A1135MKJA											

Max. pressure: 10Kg/cm<sup>2</sup>

Operating temp. range: A2335MKJA=VITON -20°C ~ +180°C

Uses: Mold specific, Mold coolant hoses

Brass mark: A0135MKJA  
Steel mark: A1135MKJA > -20°C ~ +80°C

Special seal(Packing) temperature range: -50°C ~ +300°C

Dimension of T: NPT, BSP, etc. are available to produce besides PT. (Welcome to order special threads)

## MK TYPE (ONE-HAND QUICK COUPLING)

Major Applicable Fluid~

Stainless Steel: Frozen Lubricant/Acid/Brine

Brass: Oil/Fresh Water/Air

Steel: Circulating Lubricant/Fresh Water/Air

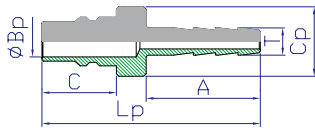

Computer No	Product Sign	Dimension (mm)						Weight (g)			Quantity per Carton
		Lp	C	Cp	A	T	Bp	SS41	BRASS	SUS	
SUS A2335MKJA	15PH	44	15	14	23	5.5	6.2	9.7	10.5	9.8	500-B
	20PH	46	15	14	25	7.2	6.2	12.9	14	13.1	500-B
BRASS A0135MKJA	25PH	46	15	14	25	9	6.2	13.9	15.1	14.1	500-B
SS41 A1135MKJA	30PH	46	15	14	25	11.3	6.2	20.3	22	20.5	500-B
	40PH	53	15	20	32	15	6.2	24	26	24.3	500-B

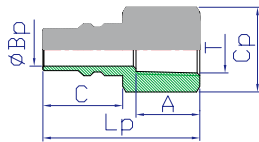

Computer No	Product Sign	Dimension (mm)					Weight (g)			Quantity per Carton	
		Lp	C	Cp	A	T	Bp	SS41	BRASS		SUS
SUS A2335MKJA	10PF	28	15	Ø16*6HEX*14D	10.5	PT1/8"28P	6.2	16.1	17.5	16.3	500-B
BRASS A0135MKJA	20PF	28	15	Ø19.5*6HEX*17D	12	PT1/4"19P	6.2	18	19.5	18.2	500-B
SS41 A1135MKJA	30PF	33	15	Ø24*6HEX*21D	16.1	PT3/8"19P	6.2	31.8	34.5	32.2	500-B

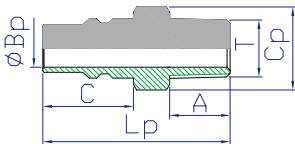

Computer No	Product Sign	Dimension (mm)						Weight (g)			Quantity per Carton
		Lp	C	Cp	A	T	Bp	SS41	BRASS	SUS	
SUS A2335MKJA	10PM	30.9	15	Ø13.7*6HEX*12D	10	PT1/8"28P	6.2	12	13	12.1	500-B
BRASS A0135MKJA	20PM	34	15	Ø19.5*6HEX*17D	13	PT1/4"19P	6.2	22.5	24.4	22.8	500-B
SS41 A1135MKJA	30PM	34	15	Ø19.5*6HEX*17D	13	PT3/8"19P	6.2	20.3	22	20.5	500-B
	40PM	34	15	Ø24*6HEX*21D	13	PT1/2"14P	6.2	36.4	39.5	36.8	500-B

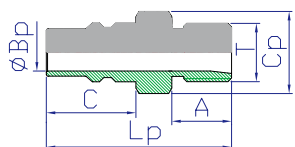

Computer No	Product Sign	Dimension (mm)						Weight (g)			Quantity per Carton
		Lp	C	Cp	A	T	Bp	SS41	BRASS	SUS	
SUS A2335MKJA	10PMS	31	15	Ø13.7*6HEX*12D	10	PS1/8"28P	6.2	9.7	10.5	9.8	500-B
BRASS A0135MKJA	20PMS	31	15	Ø19.5*6HEX*17D	10	PS1/4"19P	6.2	16.6	18	16.8	500-B
SS41 A1135MKJA	30PMS	31	15	Ø19.5*6HEX*17D	10	PS3/8"19P	6.2	17.5	19	17	500-B
	40PMS	34	15	Ø24*6HEX*21D	13	PS1/2"14P	6.2	32.7	35.5	33.1	500-B

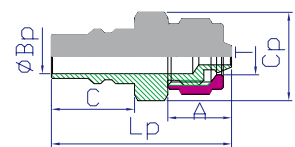

Computer No	Product Sign	Dimension (mm)						Weight (g)			Quantity per Carton
		Lp	C	Cp	A	T	Bp	SS41	BRASS	SUS	
SUS A2335MKJA	20PP	32.5	15	Ø16*6HEX*14D	11.5	4*6	6.2	15.2	16.5	15.4	500-B
BRASS A0135MKJA	25PP	34	15	Ø16*6HEX*14D	13	5*8	6.2	19.4	21	19.6	500-B
SS41 A1135MKJA	30PP	36	15	Ø19.5*6HEX*17D	15	6.5*10	6.2	29.9	32.5	30.3	500-B

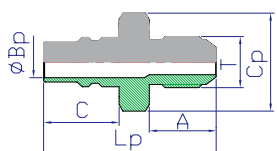

Computer No	Product Sign	Dimension (mm)						Weight (g)			Quantity per Carton
		Lp	C	Cp	A	T	Bp	SS41	BRASS	SUS	
SUS A2335MKJA	20PG	34.3	15	Ø19.5*6HEX*17D	13.3	7/16"20P	6.2	18.4	20	18.7	500-B
BRASS A0135MKJA	30PG	36	15	Ø19.5*6HEX*17D	15	9/16"18P	6.2	21.2	23	21.5	500-B
SS41 A1135MKJA	40PG	37.5	15	Ø21.7*6HEX*19D	16.5	3/4"16P	6.2	32.3	35	32.7	500-B

• Max. pressure: 10Kg/cm<sup>2</sup>

• Operating temp. range: A2335MKJA=VITON -20°C ~ +180°C

• Uses: Mold specific, Mold coolant hoses

Brass mark: A0135MKJA > -20°C ~ +80°C

Steel mark: A1135MKJA

Special seal(Packing) temperature range: -50°C ~ +300°C

Dimension of T: NPT, BSP, etc. are available to produce besides PT. (Welcome to order special threads)